

Average ETAF for Regular Landscape Areas must be 0.55 or below for residential areas, and 0.45 or below for non-residential areas.

All Landscape Areas	
Total ETAF x Area	14291
Total Area	34682
Average ETAF	0.41

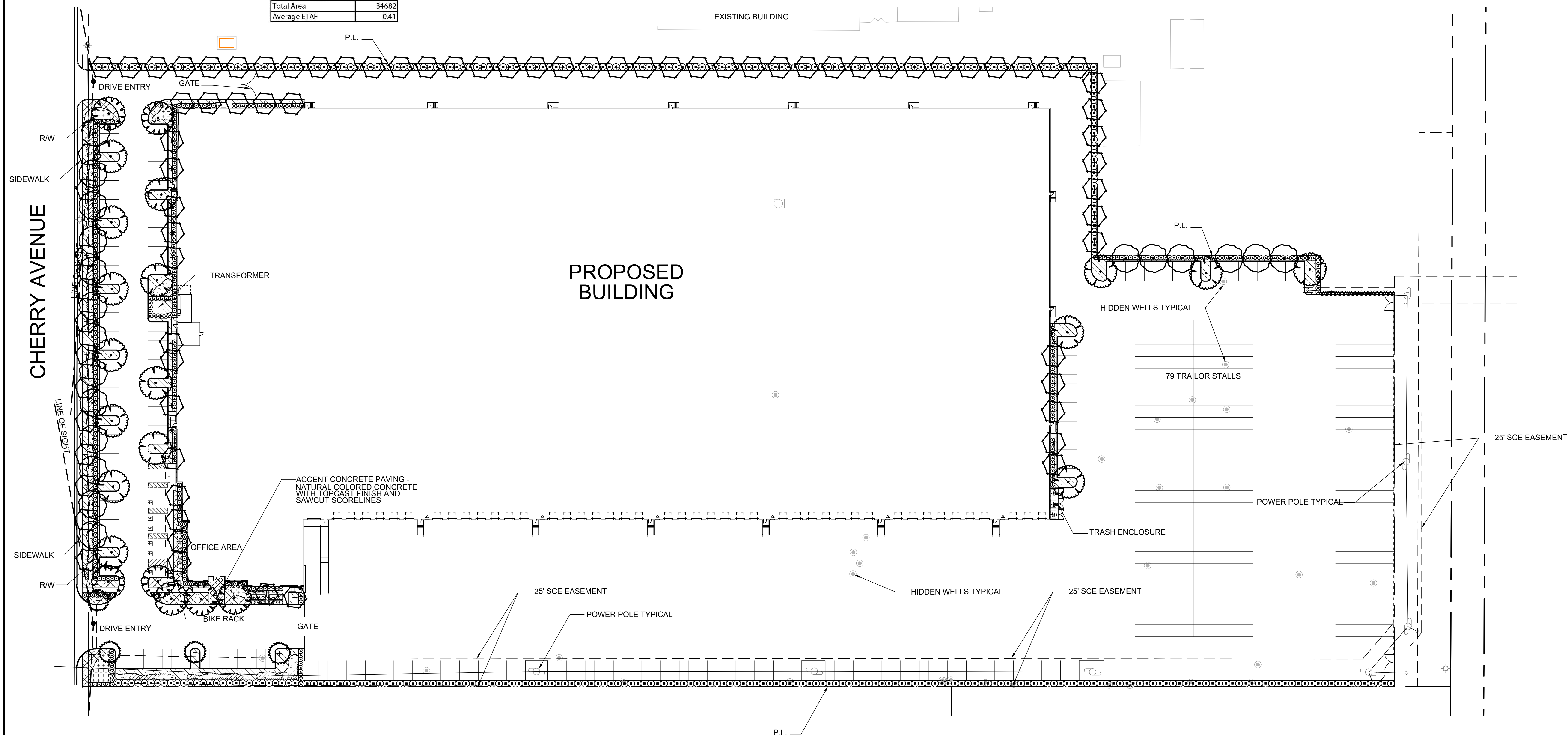

ACCENT SHRUBS - LOW WATER USE - 5 GAL
 Agave desmettiana 'Variegata' / Variegated Agave
 Agave x 'Blue Flame' / Blue Flame Agave
 Callistemon citrinus 'Little John' / Dwarf Bottle Brush
 Muhlenbergia capillaris / Pink Muhly
 Muhlenbergia lindheimeri 'Autumn Glow' / TM / Lindheimer's Muhly
 Rosmarinus officinalis 'Tuscan Blue' / Tuscan Blue Rosemary
 Salvia clevelandii 'Allen Chickering' / Cleveland Sage
 Salvia greggii 'Furmans Red' / Furman's Red Salvia

ACCENT SHRUBS - MEDIUM WATER USE - 5 GAL.
Pittosporum tenuifolium 'Marjorie Channon' / Tawhiwhi
Rhaphiolepis indica 'Jack Evans' / Indian Hawthorn
Rosa floribunda 'Iceberg' / Iceberg Rose

GROUND COVER PALETTE - LOW WATER USE - 1 GAL
Acacia redolens 'Desert Carpet' TM / Bank Catclaw
Baccharis pilularis 'Pigeon Point' / Coyote Brush
Lonicera japonica 'Halliana' / Halls Honeysuckle Flowering Vine
Myoporum parvifolium 'Putah Creek' / Putah Creek Myoporum

GROUND COVER PALETTE - MEDIUM WATER USE - 1 GAL

1. ALL TREES WITHIN 6' OF HARDSCAPE SHALL BE IN A SHAWTOWN LINEAR (WRAP AROUND NOT ALLOWED) ROOT BARRIER 24" HIGH LINEAR ROOT BARRIER SHALL BE CENTERED ON TREE AND EXTEND 5' IN BOTH DIRECTIONS FOR A TOTAL OF 10'

ALL PLANTER AREAS TO RECEIVE A 3" LAYER OF SHREDDED COVER MULCH AVAILABLE FROM EARTHWORKS (951)782-0200

NOTE: ALL LANDSCAPING IS CONSISTENT WITH STANDARDS ESTABLISHED UNDER THE STATE MODEL WATER EFFICIENT LANDSCAPE ORDINANCE (MWEL) (SECTION 21.42.035)

NOTE: EXISTING TREES WITHIN THE PUBLIC RIGHT-OF-WAY TO BE REPLACED AS A PART OF THIS PROJECT SEE EXISTING TREE PLAN

CONCEPT PLANT SCHEDULE

- ② FOUNDATION PLANTING / HEDGE SCREEN - MED WATER - 5 GAL
Buxus microphylla japonica / 'Green Beauty' / 'Green Beauty' Boxwood
Ligustrum texanum / Texas Privet
Nandina domestica / 'Heavenly Bamboo'
Podocarpus gracilis / 'Column' / Fern Pine
Raphiolepis indica 'Jack Evans' / Indian Hawthorn
Xylosma congestum / Shiny Xylosma
- LARGE SCALE PERIMETER SHRUBS - LOW WATER - 5 GAL
Arbutus unedo / 'Strawberry Tree Shrub'
Callistemon citrinus / 'Lemon Bottlebrush' Shrub
Dodonaea viscosa 'Purplea' / Purple Leafed Bushbush
Elaeagnus pungens / Silverberry
Heteromeles arbutifolia / Toyon
- ▲ SMALL SCALE FOUNDATION PLANTING - LOW WATER - 5 GAL
Callistemon citrinus 'Little John' / Dwarf Bottle Brush
Elaeagnus pungens / Silverberry
Rosmarinus officinalis 'Tuscan Blue' / Tuscan Blue Rosemary

